

Kit Name: KM10

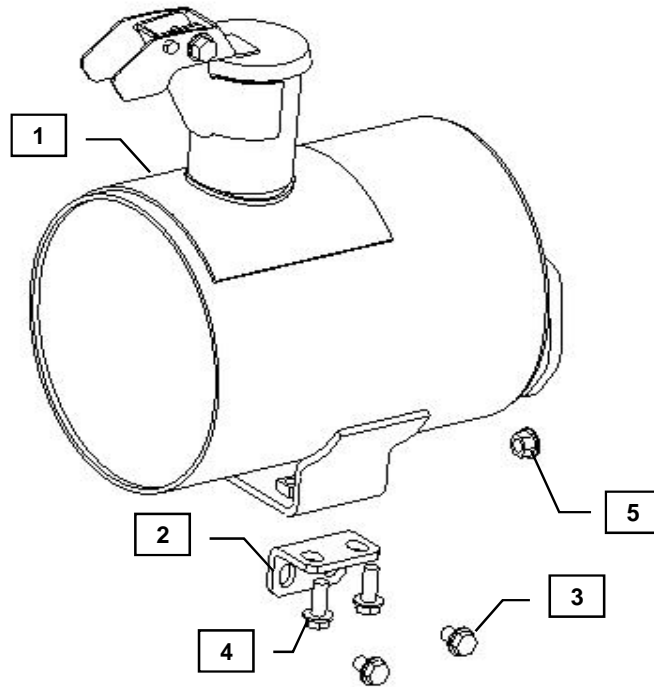

YANMAR CO., LTD.  
YANMAR AMERICA CORP.

Item	Part No.	Description	Quantity	Remarks
	D29689-13160	Muffler Kit Assembly	1	
1	129508-13521*	Muffler	1	
2	129403-13540	Support bracket, muffler	1	
3	26106-080122	Bolt, M8 x 1.25 - 12 (Flanged hex head)	2	
4	26106-080202	Bolt, M8 x 1.25 - 20 (Flanged hex head)	2	
5	26306-080002	Nut, M8 x 1.25 (Flanged hex head)	5	



**MODELS**  
4TNV84T

Notes: Parts code is not assigned to non-serviceable component parts.

Remarks:



**Installation Instructions**

**WARNING: DO NOT INSTALL THE KIT WHILE THE ENGINE IS STILL HOT**

Hand tighten all bolts and nuts until the assembly is completed, then torque to the specifications in Table 1 below.

1. Place the exhaust gasket included with the engine onto the turbocharger outlet flange.
2. Mount Muffler (1) to the turbocharger outlet using the M8x1.25 Flange Nuts (5).
3. Mount the longer side of the Muffler Bracket (2) to the exhaust manifold with M8x1.25 - 12 bolts (3)
4. Mount the Muffler (1) to the Muffler Bracket (2) using the M8x1.25 - 20 Bolts.
5. Adjust the Muffler (1) to keep the load on the Muffler Bracket (2) and NOT on the turbocharger.

**Table 1: Proper torque specifications for bolts and nuts.**

<b>Diameter x Pitch</b>	<b>Kgf-m</b>	<b>Foot-lbf</b>	<b>N-m</b>
M8 x 1.25	1.5 ~ 2.9	10.6 ~ 20.9	14.4 ~ 28.3