

Kit Name: KSC1

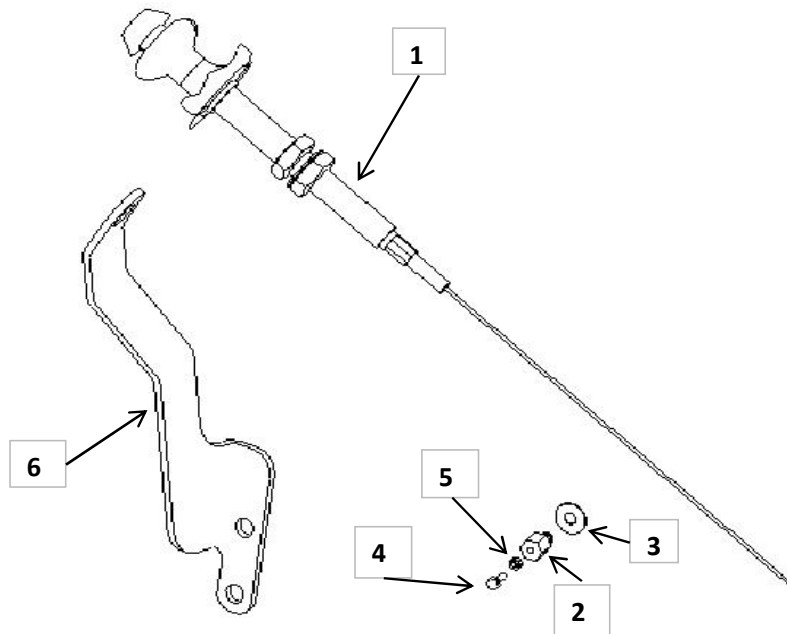

YANMAR CO., LTD.  
YANMAR AMERICA CORP.

Item	Part No.	Description	Quantity	Remarks
1	129087-66061	Cable, Throttle (Vernier)	1	
2	124756-67510	Retainer, Throttle Cable	1	
3	22272-000070	E-clip	1	
4	26116-040128	Bolt, M4x0.7-12	1	
5	26716-040002	Nut, M4x0.7	1	
6	129689-91140	Bracket, Throttle Cable	1	



**MODELS**

**Tier 2/3/IT4**

3TNV82A  
3TNV88  
3TNV84T  
4TNV88  
4TNV84T

**Tier 2 Only**

4TNV98  
4TNV98T

Notes: Parts code is not assigned to non-servicable component parts.

Remarks:



## Installation Instructions

Hand tighten all bolts and nuts until assembly is completed, then torque according to specifications in Table 1.

The numbers in ( ) below reference the item numbers on page 1.

1. Fasten the Throttle Cable Bracket (6) on the engine rear mounting pad with hex bolts (Not Provided). Tighten to torque in table below.
2. Remove the nut and washer from the end of the Speed Control Assembly (1) and insert the Speed Control Assembly through the hole on the Throttle Cable Bracket (6). Re-Install the washer and nut and tighten.
3. Insert the Retainer (2) to lower hole of the throttle control lever and secure it with E-Clip (3).
4. Insert Speed Control Assembly wire in the Retainer (2), and make sure the speed control knob is all the way down. Thread M4 Nut (5) onto the M4 Bolt (4) and install in threaded hole on Retainer (2). Tighten enough to secure throttle cable, but be careful to not break the M4 Bolt. Tighten M4 Nut (5) against the Retainer (2) to prevent cable from coming loose. After tightening, make sure throttle control lever reaches both High Idle and Low Idle stops.
5. The wire should extend at least 10mm (0.4 inches) from the wire retainer. Cut off excess wire.

NOTE: Comply with torque standards in the table to avoid unexpected damage during installation or in the future.

**Table 1: Tightening Torque**

Diameter x Pitch	Kgf-m	Foot-lbf	N-m
M8 x 1.25	1.5 ~ 2.9	10.6 ~ 20.9	14.4 ~ 28.3
M10 x 1.50	4.5 ~ 5.5	32.5 ~ 39.8	44.0 ~ 54.0
M12 x 1.75	8.0 ~ 10.0	57.8 ~ 72.3	78.4 ~ 98.0