

NEED	○	PURCHASING SPECIFICATION	REQUEST FOR APPROVAL	DELIVERY DRAWING	INSPECTING STANDARD	QC-PROCESS	3RD ANGLE PROJECTION																
GEN. TOL.		TRAFT ANG.	OUTSIDE	INSIDE	NOMINAL DIM DIVISION	5 MAX	5 TO	10 TO	18 TO	30 TO	120 TO	250 TO	400 TO	800 TO	1600 TO	0.5 TO	6	±0.1	400 TO	1000	±0.8	10 MAX	±IDEG.
			2/100	3/100	SANDMOLD	±1.0	±1.5	±2.0	±3.0	±3.5	±1.5	±2.0	±3.0	±4.0	±5.0	±1.5	±2.0	±2.0	1000 TO	2000	±1.2	50 TO	±20MIN
			3/100		SHELL	±0.8	±1.0	±1.5	±2.0	±2.0	±1.0	±1.5	±2.0	±3.0	±4.0	±6.0	±2.0	±2.0	2000 TO	4000	±2.0	120 TO	±10MIN

FIGURE DIMENSION	GT.CODE	○ AND √: RADIAL	CAREER
			(2008.11.25) エンジン標準外形図として図面新装する。 Release of outline drawing as standard engine. (図庫)

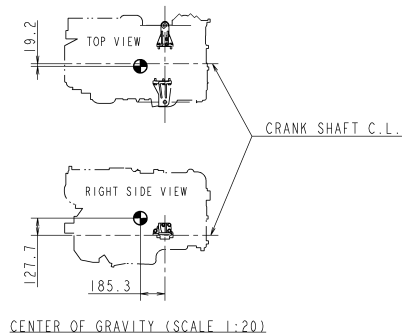
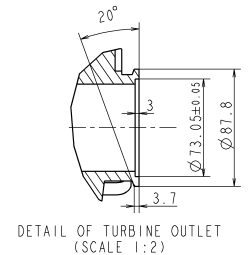
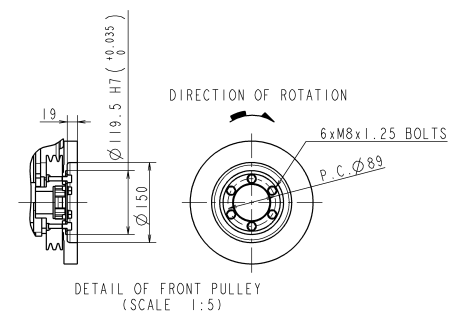
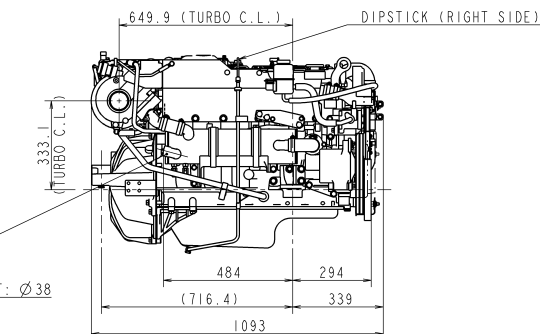
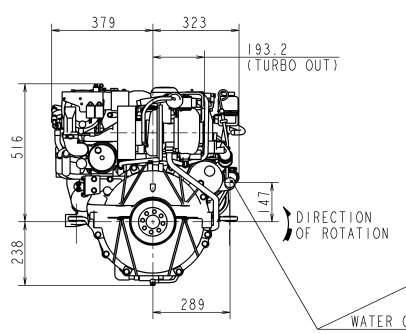
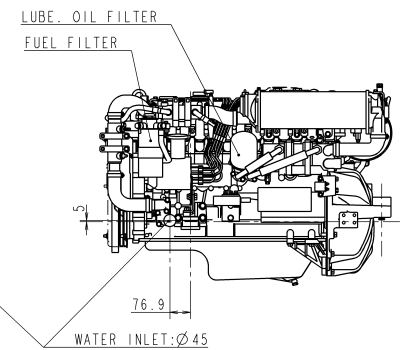
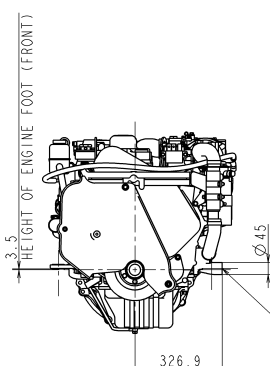
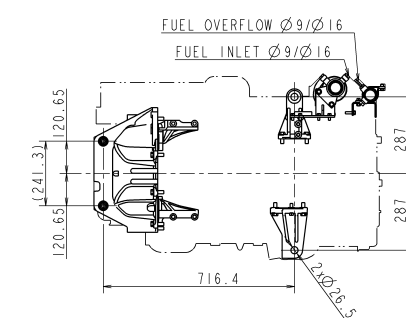
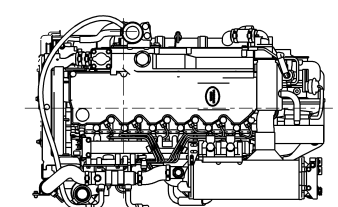
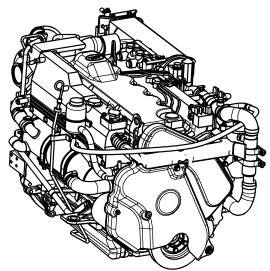

Conform to the former standard JIS V-D0011 concerning "the limitation of the environmental burden material" for the use of the environmental burden material of this part.

本製品の環境負荷低減を図るため、JIS V-D0011 環境負荷低減に関する規定に準拠して製造されています。

3D-CAD

NOTICE

GEOMETRICAL TOLERANCE

SYMBOL

SCALE

PROJECTION

LOCATION

DATE

REVISION

DESCRIPTION

BY

CHECKED

DATE

APP. NAME

DATE

CAD data information of this drawing.

CAD SYSTEM	Pro/Engineer wildfire 2.0
FILE ARCHIVER	ZIP
ARCHIVE FILE NAME	B2-19779-0390_rev0.zip

SPECIFICATIONS		
Engine Model	-	6LPA-ST2P2
Fuel Stop Power (Flywheel Output)	ISO 8665; 1994	kW / min ⁻¹ 232 / 3800
		PS / rpm 315 / 3800
	ISO 8665; 2006	kW / min ⁻¹ 222 / 3800
		PS / rpm 302 / 3800
Direction of Crank Shaft Rotation	-	COUNTER CLOCKWISE AT FLYWHEEL SIDE
Dry Mass	kg (lb)	APPROX. 428 (944)

材料質量 MASS(DRAW) (kg) (±%)	kg (±%)		MANAGER	
完成質量 MASS (%) (±%)	kg (±%)		梶	
SEC.MANAGER 梶岡 敬次	SPECIALIST	MODEL 6LPA-ST2P2	SCALE 1:10	
CHECKED 中村 岳保	QTY -	MATERIAL -		
DESIGNED T.Miyajima	DRAWN Y.Kakidachi	DATE: 2008.11.25	6LPA-ST2P2 ENGINE OUTLINE DRAWING	
YANMAR			CODE B2-19779-0390	REV. 01
YANMAR CO., LTD. DEVELOPMENT DEPT.				