

DETAIL OF PULLEY (1/5)

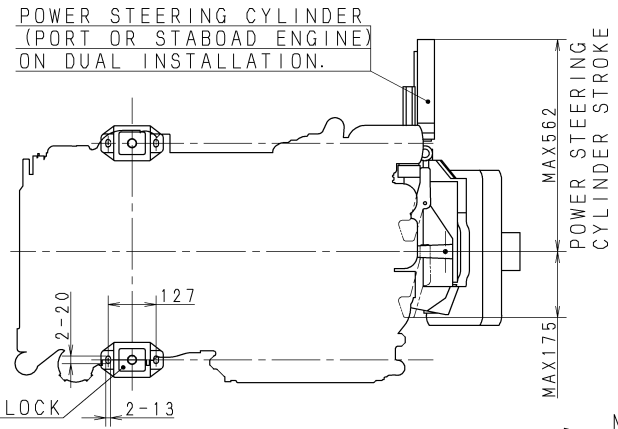

MOUNTING BLOCK

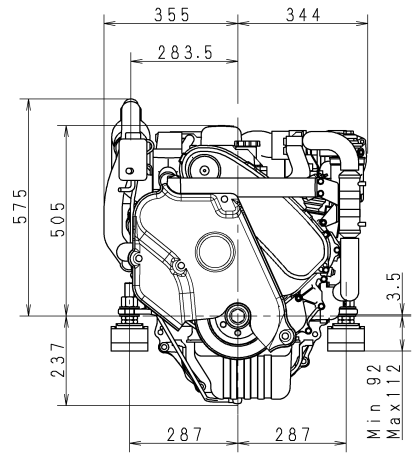

FUEL INLET  
φ9/φ16  
FUEL OVERFLOW  
φ9/φ16  
SEAWATER INLET  
φ44.5

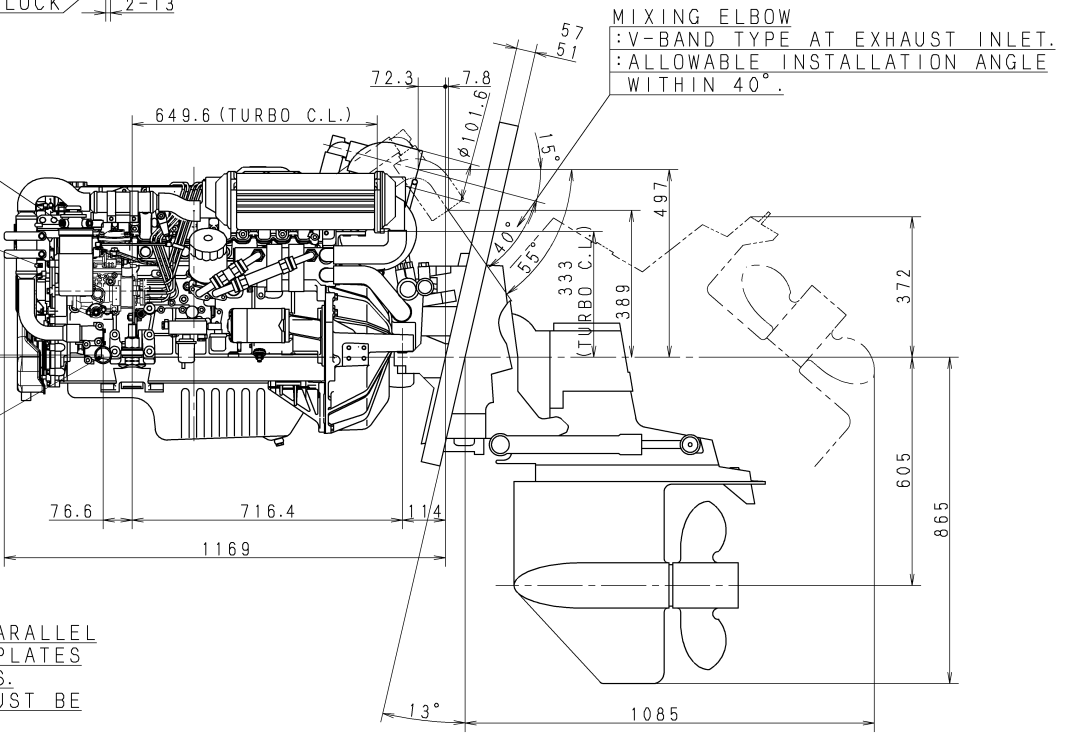

MIXING ELBOW  
:V-BAND TYPE AT EXHAUST INLET.  
:ALLOWABLE INSTALLATION ANGLE  
WITHIN 40°.

- NOTE:
- INNER AND OUTER TRANSOM SURFACE MUST BE PARALLEL WITHIN 3mm IN AREA OF COVERED BY TRANSOM PLATES AND REMAIN WITHIN TRANSOM THICKNESS LIMITS.
  - AREA COVERED BY GIMBAL HOUSING ASSEMBLY MUST BE FLAT TO WITHIN 1.6mm
  - AREA COVERED BY INNER TRANSOM PLATE MUST BE FLAT TO WITHIN 3.2mm.
  - TRANSOM ANGLE : 13° to 16°
  - DWG. SHOWS MOUNTING BLOCKS AT COMPRESSED HEIGHT. (FRONT:COMPRESSED BY APPROX. 4MM REAR:COMPRESSED BY APPROX. 0.6MM)

SPECIFICATIONS		MODEL	
		6LPA-STZP2	
CONT. RAITING OUTPUT (FLYWHEEL OUTPUT)	kW/rpm	211/3682	
	HP/rpm	286/3682	
MAX OUTPUT (FLYWHEEL OUTPUT)	kW/rpm	232/3800	
	HP/rpm	315/3800	
DRY WEIGHT	kg (lb)	APPROX. 428 (944)	
REDUCTION RATIO		1.50	1.65   1.81   2.00
DIRECTION OF PROP. SHAFT ROTATION		COUNTER-CLOCKWISE	

長 SEC. MANAGER 松岡	機種 MODEL 6LPA-STZP2	個数 QTY. -	材料 MATERIAL ---	尺度 SCALE 1:10 (1:5)
株 CHECKED 藤沢	機務担当者 SPECIALIST	名称 NAME 6LPA-STZP2 X BRAVO2 OUTLINE	図 CODE B2-19779-0320	部 MANAGER 梶
設 DESIGNED T. Nakamura	製 DRAWN	年 DATE	YANMAR CO., LTD. DEVELOPMENT DEPT.	

部長 MANAGER 梶	図 A2
--------------------	---------