

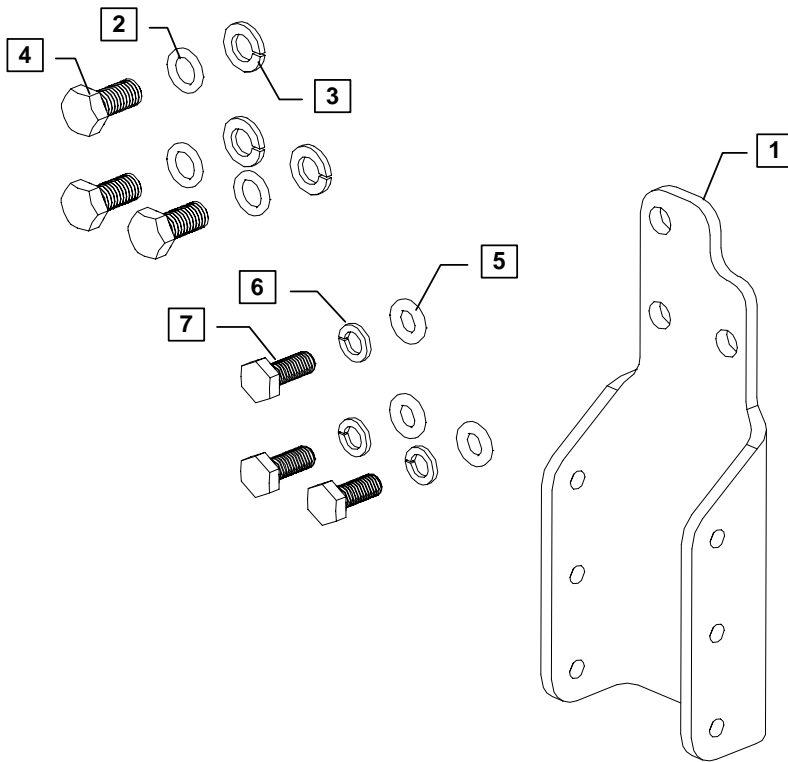

**YANMAR CO., LTD.**  
YANMAR AMERICA CORP.

| Item   | Lev. | O | Part No.     | Description                                 | Quantity | Remarks |
|--------|------|---|--------------|---|----------|---------|
| 1 to 7 | -    |   | 729689-91160 | Panel Bracket Assy                          | 1        |         |
| 1      | --   |   | 129689-91160 | Panel Bracket                               | 1        |         |
| 2      | --   |   | -            | Plain Washer, 12mm, Regular, (ANSI B18.22M) | 3        | (A)     |
| 3      | --   |   | -            | Helical Spring Lock Washer, 12mm, (BS 4464) | 3        | (A)     |
| 4      | --   |   | -            | M12-1.75x25, Hex Cap Screws, (DIN 933)      | 3        | (A)     |
| 5      | --   |   | -            | Plain Washer, 10mm Regular, (ANSI B18.22M)  | 3        | (B)     |
| 6      | --   |   | -            | Helical Spring Lock Washer, 10mm, (BS 4464) | 3        | (B)     |
| 7      | --   |   | -            | M10-1.5 x 25, Hex Cap Screw, (DIN 933)      | 3        | (B)     |
| 8      |      |   |              |   |          |         |



**MODELS**  
All TNV

Remarks: (A) Replace item 2, 3, 4 with M12x20 bolt 26106-120202.  
(B) Replace item 5,6, 7 with M10x20 bolt 26106-100202.



---

---

## Installation Instructions

---

---

Hand tighten all bolts and nuts until assembly is completed, then torque according to specifications in Table 1. The numbers in () represent the item numbers.

This kit is used when the rear legs are not required.

This is typical for a Generator type application.

- 1 Mount Panel Bracket (1) to rear-right engine mounting pad with Washer (2), Lock Washer (3) and M10 x 25 bolt (4). If engine model is 3TNV82A, replace Washers and Bolts with M12 size fasteners (5), (6), (7)..

NOTE: Comply with torque standards in the table to avoid unexpected damage during installation or in the future.

| Diameter x Pitch | Kgf-m      | Foot-lbf    | N-m         |
|------------------|------------|-------------|-------------|
| M8 x 1.25        | 1.5 ~ 2.9  | 10.6 ~ 20.9 | 14.4 ~ 28.3 |
| M10 x 1.50       | 4.5 ~ 5.5  | 32.5 ~ 39.8 | 44.0 ~ 54.0 |
| M12 x 1.75       | 8.0 ~ 10.0 | 57.8 ~ 72.3 | 78.4 ~ 98.0 |